

### SAFETY INSTRUCTIONS

Owner must ensure that all players know and follow these rules for safe operation of the system.

To ensure safety, do not attempt to assemble this system without following the instructions carefully. Check entire box and inside all packing material for parts and/or additional instruction material. Before beginning assembly, read the instructions and identify parts using the hardware identifier and parts list in this document. Proper and complete assembly, use, and supervision are essential for proper operation and to reduce the risk of accident or injury. A high probability of serious injury exists if this system is not installed, maintained, and operated properly.

- If using a ladder during assembly, use extreme caution.
- Two(2) capable adults are recommended for this operation.
- Check base regularly for leakage. Slow leaks could cause system to tip over unexpectedly.
- Seat the pole sections properly(if applicable). Failure to do so could allow the pole sections to separate during play and/or transport of the system.
- Climate, corrosion, or misuse could result in system failure
- Minimum operational height is 66"(1.98 m) to the bottom of backboard.
- This equipment is intended for home recreational use only and NOT excessive competitive play\*Read and understand the warning label affixed to pole.
- The life of your basketball pole depends on many conditions. The climate placement of the pole location of the pole exposure to corrosives such as pesticides, herbicides or salts are all important.
- Adult supervision is recommended when adjusting height.

### **Notice to assemblers:**

All the basketball systems, including those used for displays, must be assembled and ballasted according to instructions. Failure to follow instructions could result in serious injury.

Please read all warnings and cautions before assembly. It is recommended to supervise children as they play with this product. This product is to be assembled by 2 adults only!

We appreciate your purchasing one of our many fine products. We are assure that you will be very satisfied with your selection.

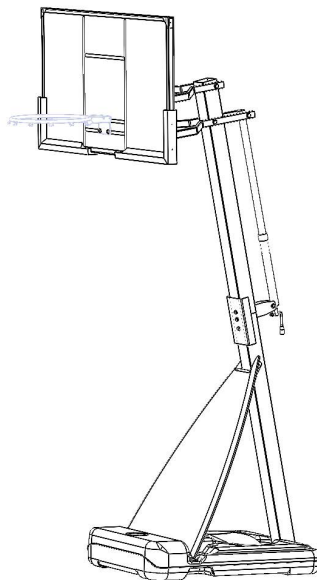

**ANBOO**  
**www.anboo.co**  
**Tel:0086-523-86665602**  
**Wechat:13795289053**  
**E-mail:Service@anboo.co**

Please confirm that the following accessories are complete after opening the package.

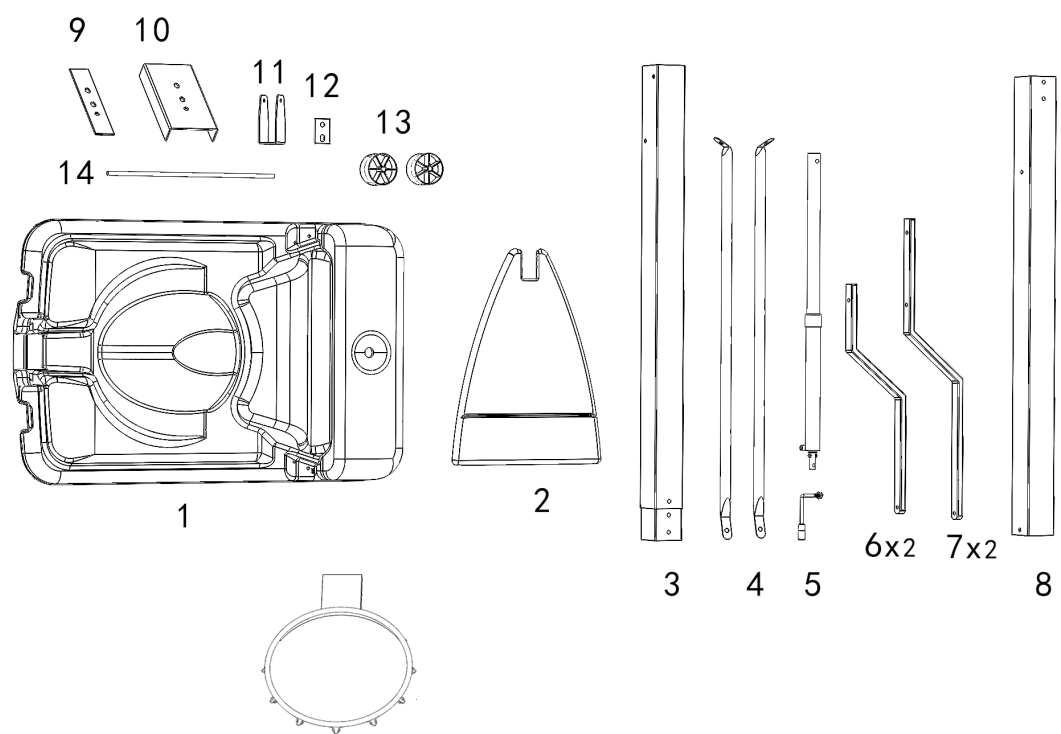
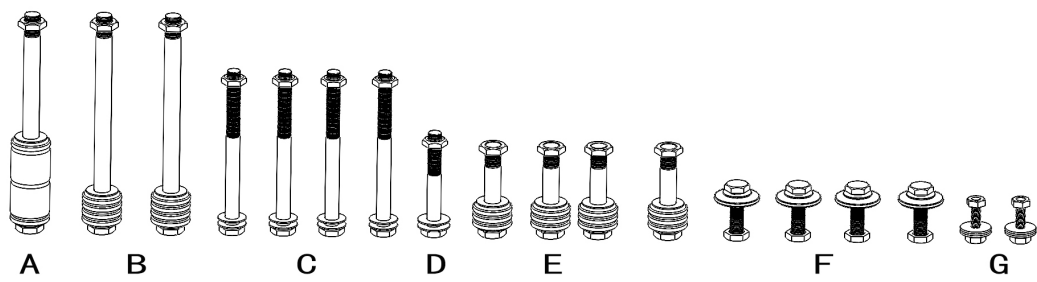

## Installation Steps:

1. Connect the base (14) with the main rod (8) by part (1). Install the wheels (13) on both sides of the part (14). And place the wheel (13) in the corresponding position of the base (1). Connect the tie rod (4) with the main rod (8) by bolt (C). And connect the tie rod (4) to the base (1) through the bolt (G). Please pay attention to the mounting orientation of each part when installing.

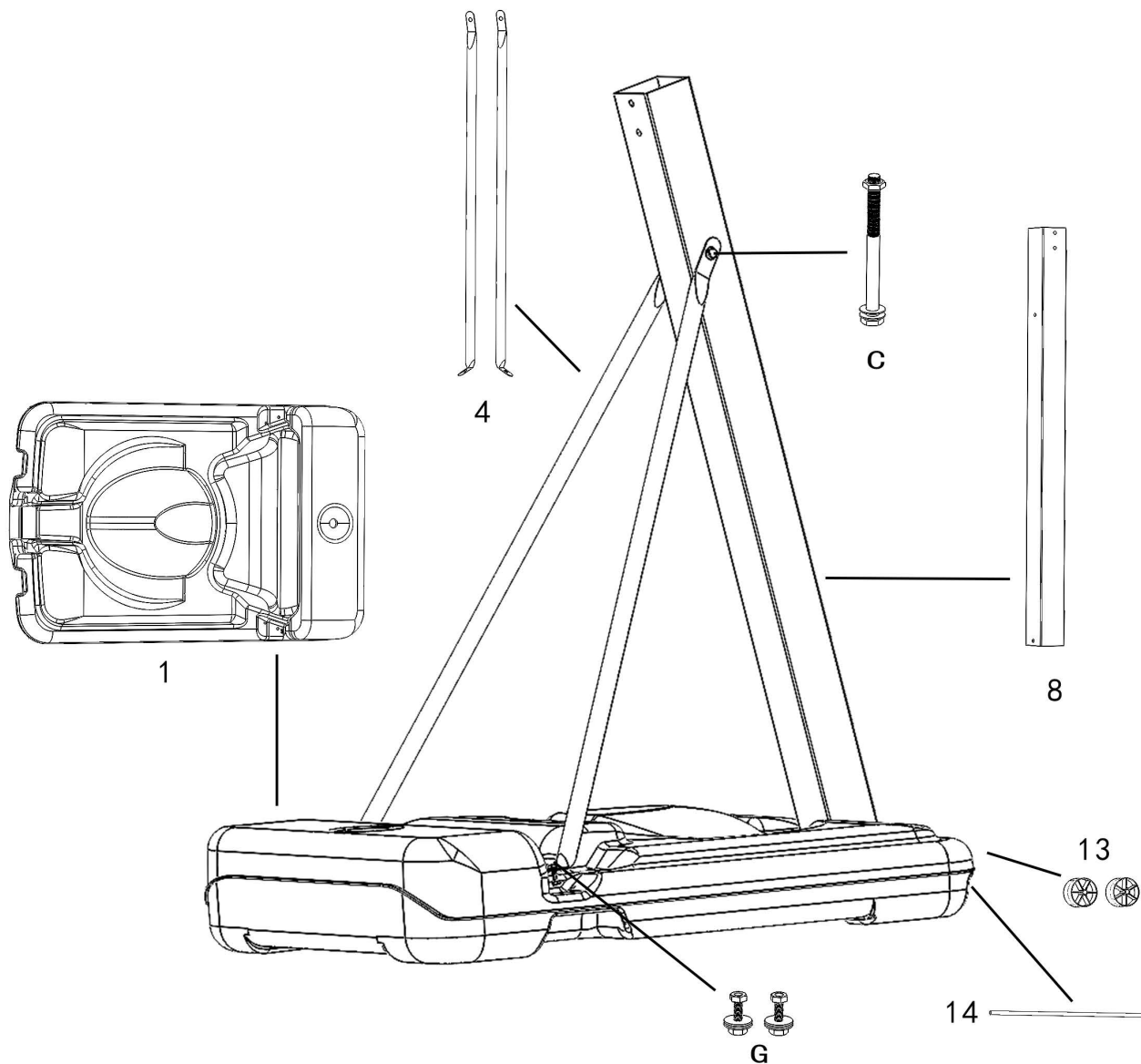

2.Insert the main rod (3) into the main rod (8), referring to the front and rear mounting directions in the figure below. Clamp part (10) at the front end of the connection of the two main rods, place part (9) on the back of the main rod, and place part (11) behind part (9) and part (12) in part (11), pay attention to the up and down direction of the hole position, and connect the above parts through three bolts (C).

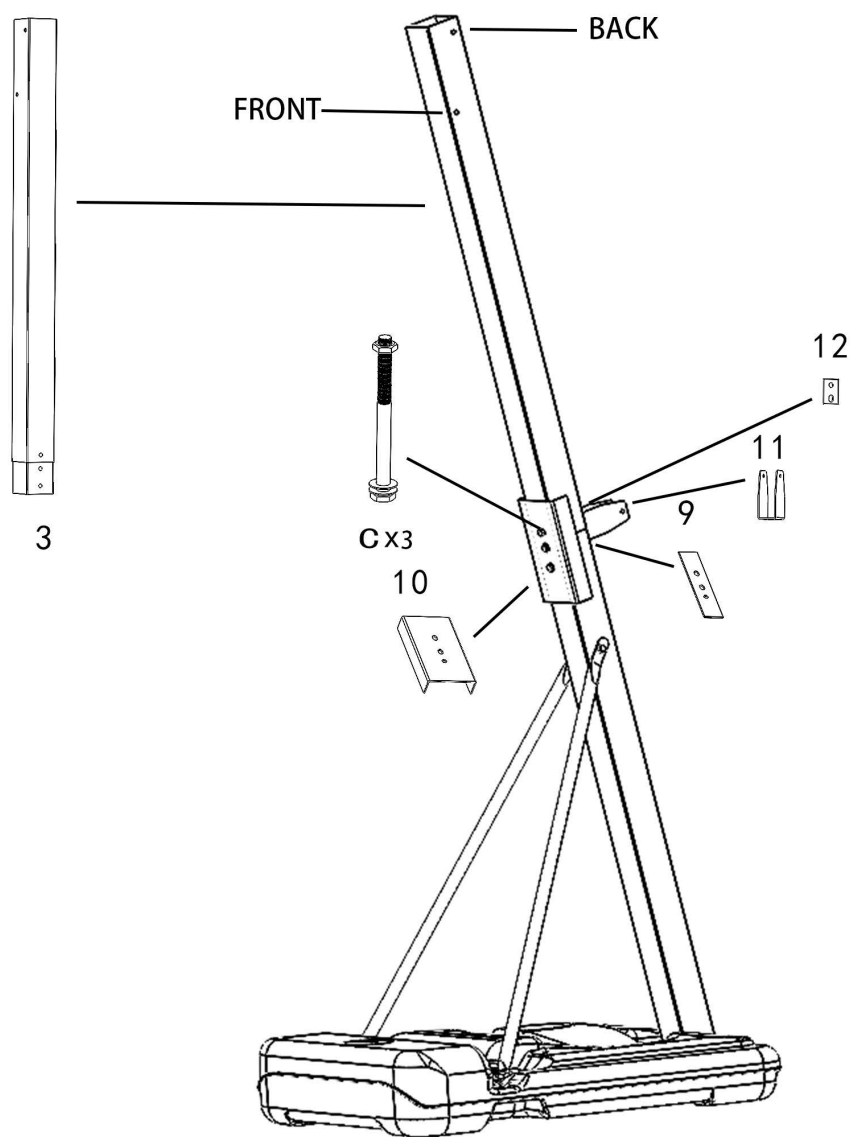

3. Connect the lifting rod (5) to the hole position on the part (11) by means of bolt (D).  
Adjust the hole at the top of the lifting rod (5) to the transverse position by means of a hand crank.

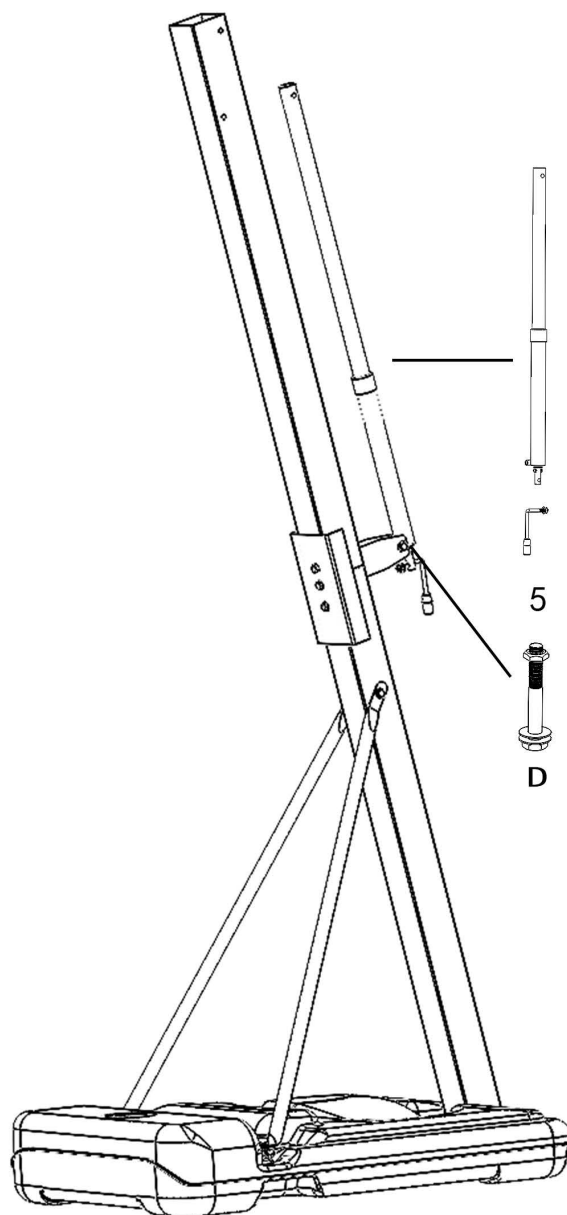

4. Connect the two brackets (7) to the holes in front of the main rod (3) by means of bolts (B). Connect the lifting rod (5) to the hole at the rear of the bracket (7) by bolt (A). Connect the two brackets (6) to the holes at the rear of the main rod (3) by means of bolts (B). When installing, pay attention to the front and rear orientation of the bracket and place the spacers attached to the bolts in the corresponding gaps.

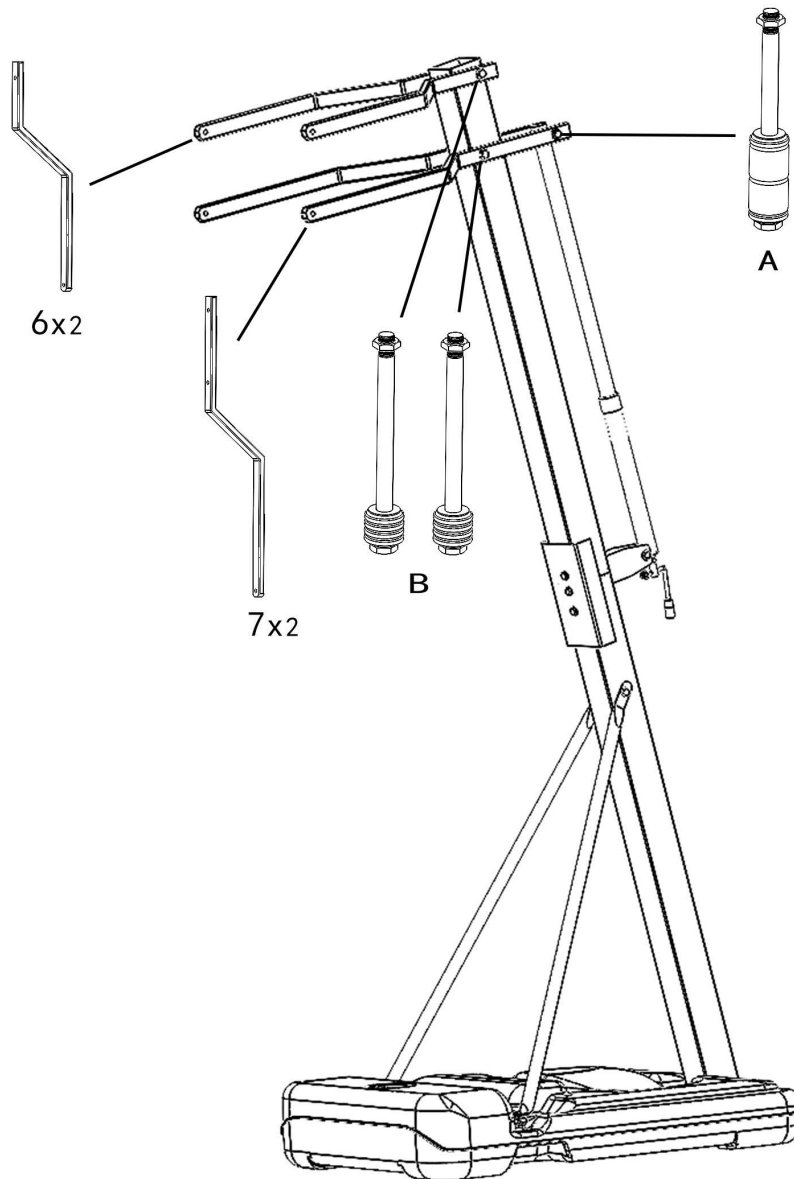

5. Connect the basketball board to the 4 holes on the bracket through 4 bolts (E). When installing, it is recommended to place the basketball hoop horizontally on the ground to avoid falling and smashing injuries.

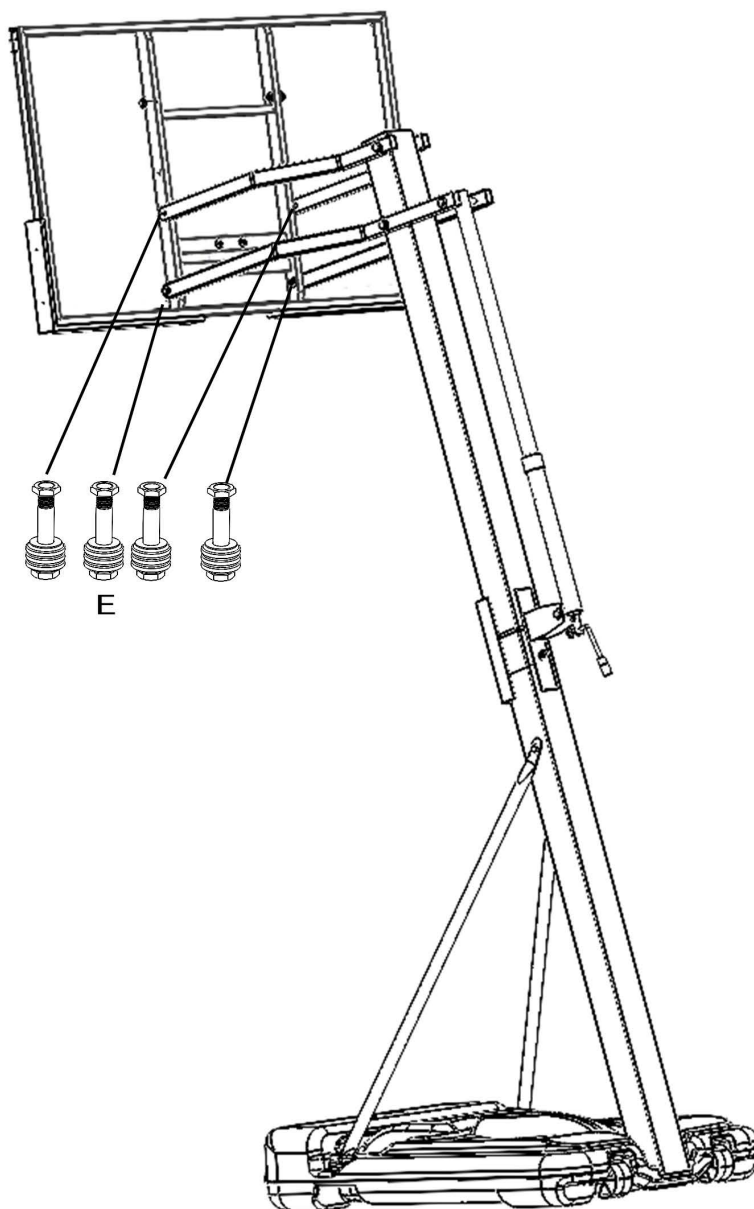

6. Connect the basketball hoop to the basketball board by 4 bolts (F). Place the bezel (2) on the tie rod (4). Hang the net on the basketball ring. Control the height of the basketball hoop from the ground by adjusting the length of the lifting rod (5).

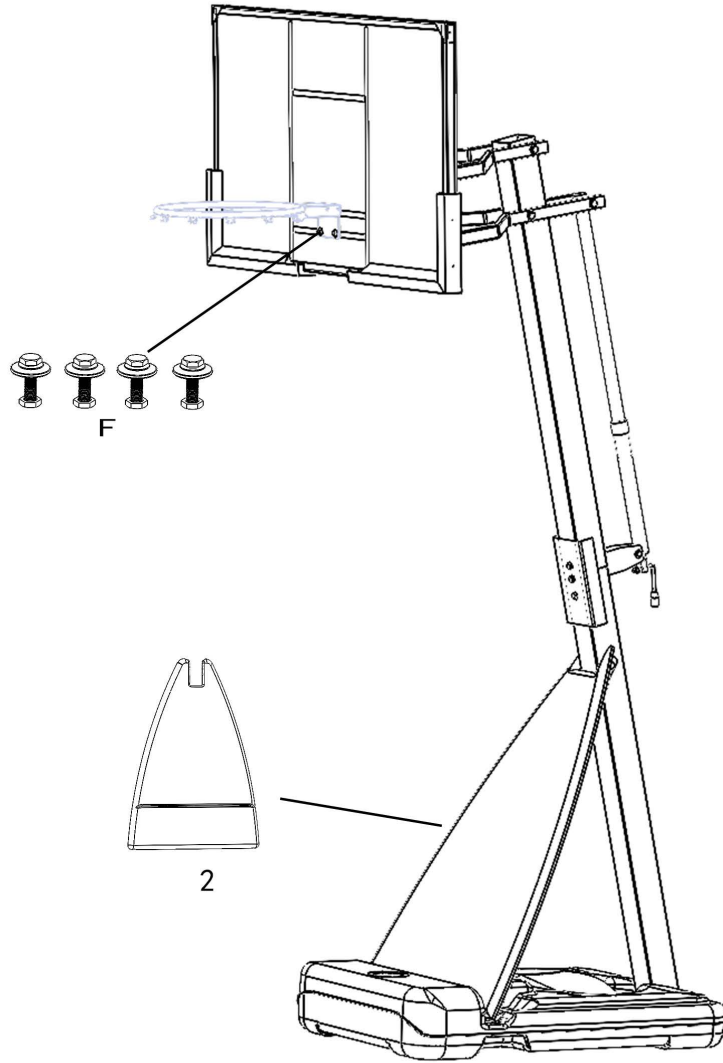

**Precautions:**

1. When installing, it is recommended to place the basketball hoop at the ground level for installation, and then erect the basketball hoop after installing all the components.
2. After installing all the parts, tighten all the bolts in case some parts need to be adjusted.
3. After erecting the basketball hoop, immediately load the sand for counterweight, it is recommended to pour 6 bags of 20 kg of water.
4. For safety, Please add additional counterweights.

**ANBOO**  
**PRODUCTS**

**ANBOO**  
**www.anboo.co**  
**Tel:0086-523-86665602**  
**Wechat:13795289053**  
**E-mail:Service@anboo.co**